

NITRIDED EJECTOR SLEEVES

Parker Nitrided Ejector Sleeves are made of the finest grade of hot work die steel. The heads are hot-forged for strength. The outside surface is nitrided to a hardness of 64-74 Rockwell "C" and GROUND AFTER NITRIDING FOR STRAIGHTNESS AND FINISH. The bearing diameter is 300 Brinell and is finished, reamed and honed concentric with the O.D. of the sleeve.

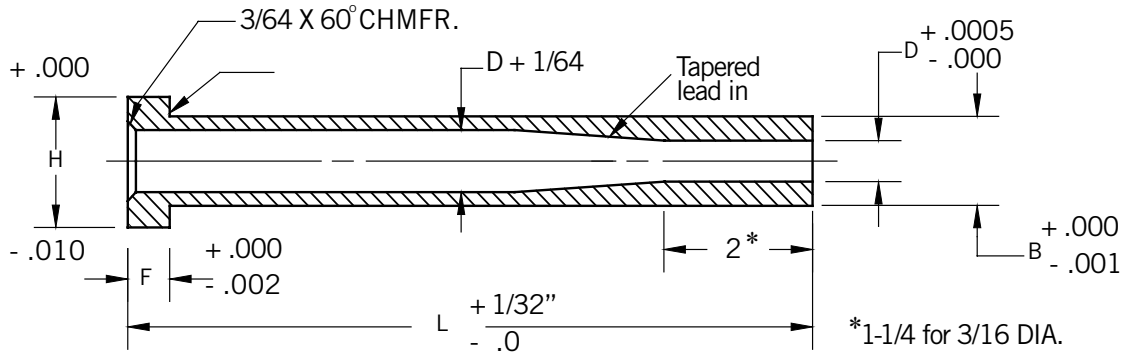

| Cat. No. | B O.D. | D I.D. | H Head Dia. | F Head Thick. |
|----------|--------|--------|-------------|---------------|
| ES187 | 3/16 | 3/32 | 3/8 | 3/16 |
| ES 203 | 13/64 | 7/64 | 3/8 | 3/16 |
| ES 218 | 7/32 | 1/8 | 13/32 | 3/16 |
| ES 250 | 1/4 | 5/32 | 7/16 | 3/16 |
| ES 312 | 5/16 | 3/16 | 1/2 | 1/4 |
| ES 343 | 11/32 | 7/32 | 9/16 | 1/4 |
| ES 375 | 3/8 | 1/4 | 5/8 | 1/4 |
| ES 437 | 7/16 | 5/16 | 11/16 | 1/4 |
| ES 500 | 1/2 | 3/8 | 3/4 | 1/4 |
| ES 625 | 5/8 | 7/16 | 7/8 | 1/4 |
| ES 687 | 11/16 | 1/2 | 15/16 | 1/4 |
| ES 750 | 3/4 | 9/16 | 1 | 1/4 |
| ES 875 | 7/8 | 5/8 | 1-1/8 | 1/4 |
| ES 1000 | 1 | 3/4 | 1-1/4 | 1/4 |

Special material and sizes available to your specifications

Note: Standard Lengths: 4" - 14"

Parker Precision Products Company now offers a line of oversize diameter ejector sleeves made of the same quality and material as the standard sleeve.

| Cat. No. | *B O.D. | D I.D. | H Head Dia. | F Head Thick. |
|----------|---------|--------|-------------|---------------|
| ES 192 | 3/16 | 3/32 | 3/8 | 3/16 |
| ES 255 | 1/4 | 5/32 | 7/16 | 3/16 |
| ES 317 | 5/16 | 3/16 | 1/2 | 1/4 |
| ES 380 | 3/8 | 1/4 | 5/8 | 1/4 |
| ES 442 | 7/16 | 5/16 | 11/16 | 1/4 |
| ES 505 | 1/2 | 3/8 | 3/4 | 1/4 |

Note: Standard Lengths: 4" - 14"

* O.D. size is +.005 over standard "B" dimension



Parker Precision Products
The First Name in Quality Metal Punches
Phone: 800-526-1378 www.parkerprecisionproducts.com